

28.Extension Case

A: REMOVAL

- 1) Remove the transmission assembly from the vehicle. <Ref. to CVT(TR690)-56, REMOVAL, Automatic Transmission Assembly.>
- 2) Remove the front wheel speed sensor. <Ref. to CVT(TR690)-105, REMOVAL, Front Wheel Speed Sensor.>
- 3) Remove the rear wheel speed sensor. <Ref. to CVT(TR690)-107, REMOVAL, Rear Wheel Speed Sensor.>
- 4) Remove the harness clip, and remove the extension case.

NOTE:

The total number of extension case mounting bolts is 10.

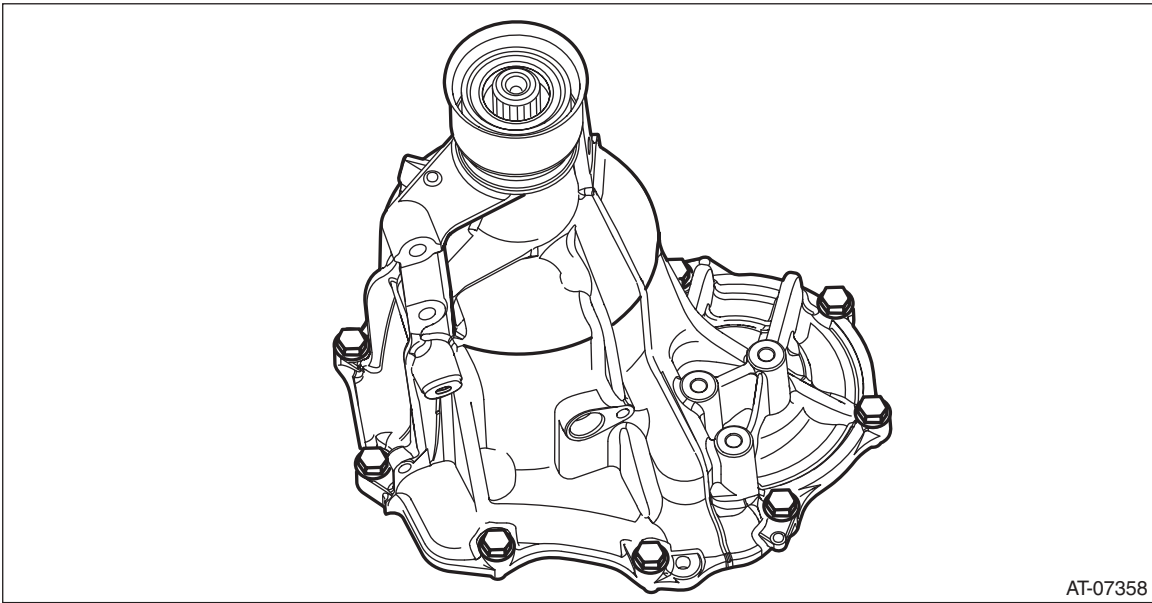

AT-07358

B: INSTALLATION

- 1) Clean the mating surface of the extension case and intermediate case.
- 2) Select the rear drive shaft shim. <Ref. to CVT(TR690)-149, ADJUSTMENT, Rear Drive Shaft.>
- 3) Select the shim for transfer reduction driven gear. <Ref. to CVT(TR690)-161, ADJUSTMENT, Transfer Reduction Driven Gear.>
- 4) Install the selected rear drive shaft shims to the rear drive shaft.
- 5) Attach the selected shim to transfer reduction driven gear assembly.
- 6) Install the gasket and the extension case.

NOTE:

Use a new gasket.

Tightening torque:

25 N·m (2.5 kgf-m, 18.4 ft-lb)

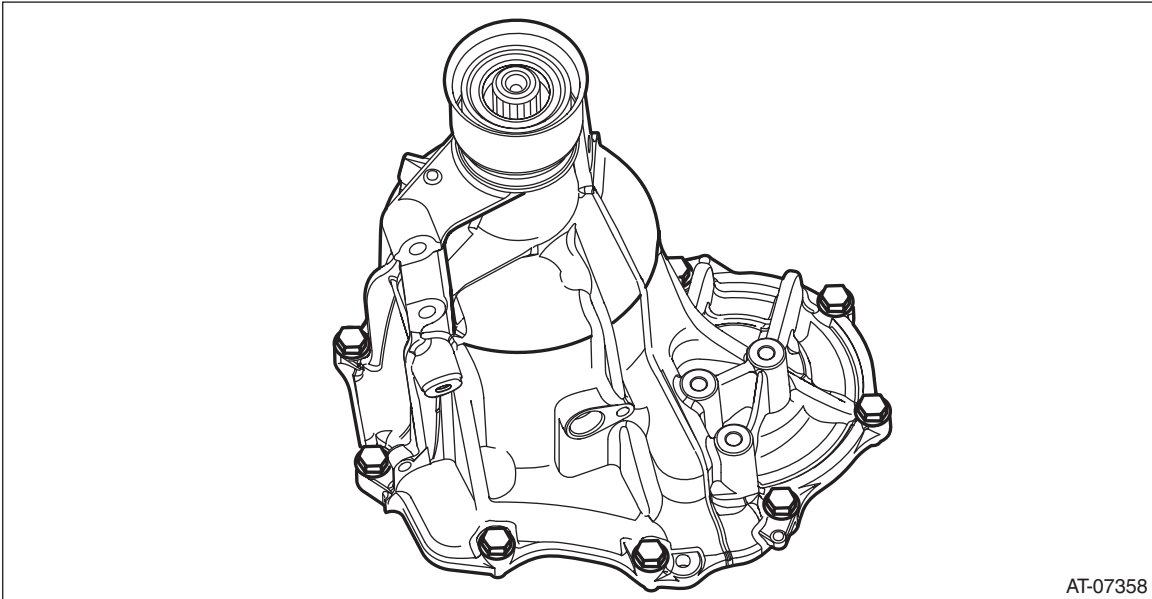

AT-07358

- 7) Install the rear wheel speed sensor. <Ref. to CVT(TR690)-108, INSTALLATION, Rear Wheel Speed Sensor.>
- 8) Install the front wheel speed sensor. <Ref. to CVT(TR690)-105, INSTALLATION, Front Wheel Speed Sensor.>
- 9) Install the transmission assembly. <Ref. to CVT(TR690)-69, INSTALLATION, Automatic Transmission Assembly.>

Extension Case

CONTINUOUSLY VARIABLE TRANSMISSION

C: DISASSEMBLY

- 1) Remove the dust cover from extension case.
- 2) Remove the snap ring using the ST and press.

CAUTION:

If the operation is performed with the dust cover installed, place a table between the extension case and the press table.

ST 18762AA001 COMPRESSOR SPECIAL TOOL

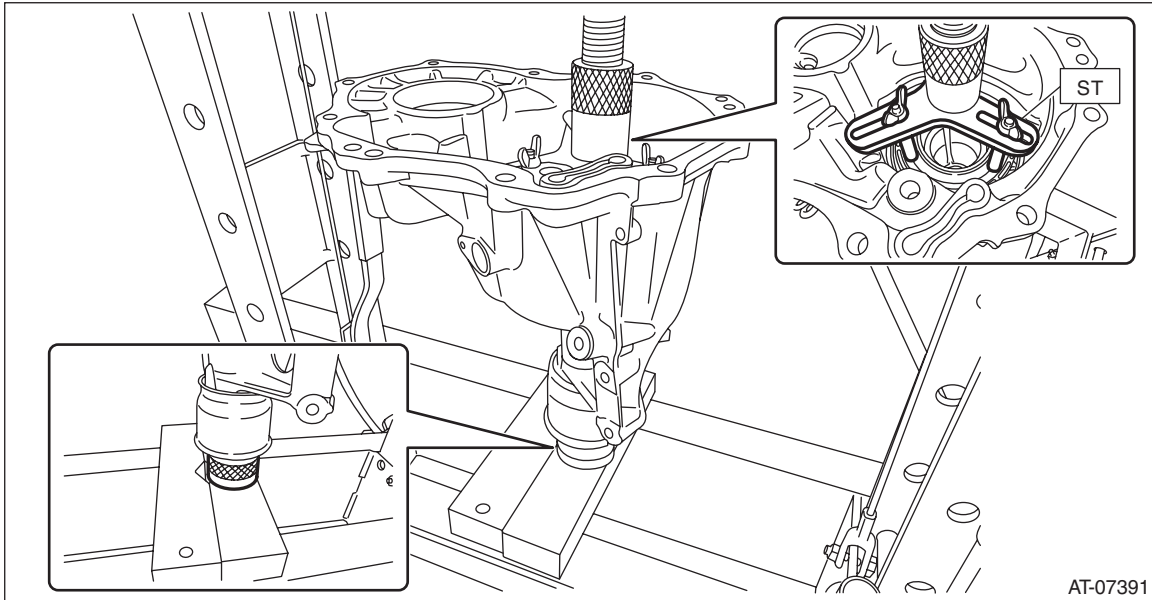

- 3) Supply compressed air to remove the transfer clutch piston.

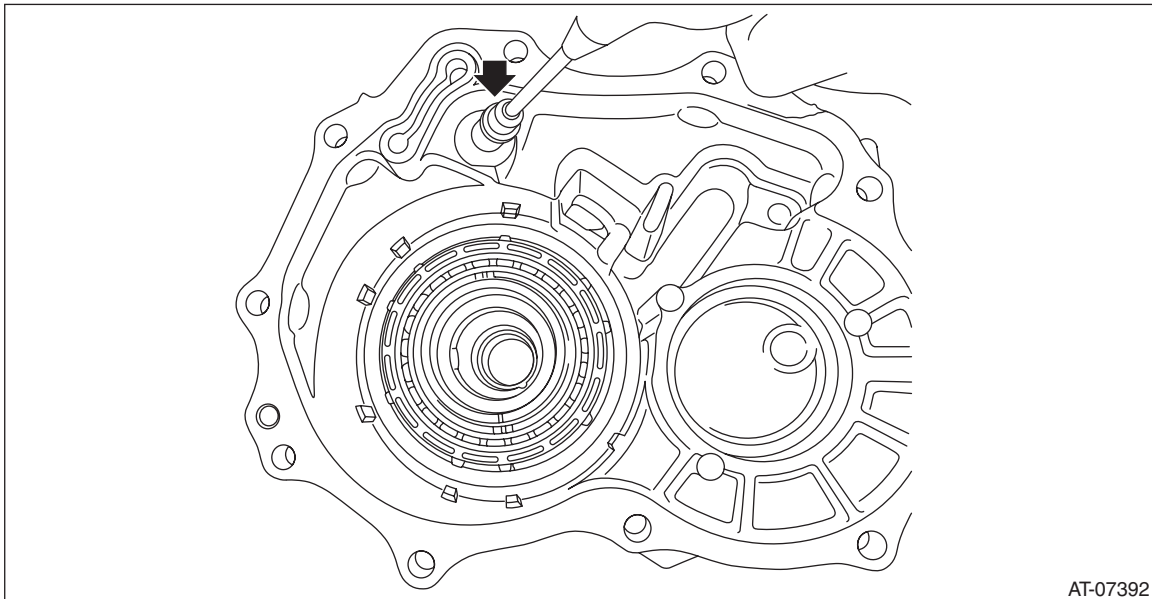

- 4) Remove the D-ring and O-ring from the transfer clutch piston.
- 5) Remove the extension case oil seal from the extension case.
- 6) Remove the plug from the extension case.

D: ASSEMBLY

1) Install the O-ring and plug.

NOTE:

Use new O-rings.

Tightening torque:

25 N·m (2.5 kgf-m, 18.4 ft-lb)

2) Install the D-ring and O-ring to the transfer clutch piston.

NOTE:

- Use new D-rings and O-rings.
 - Apply CVTF to the D-rings and O-rings of the transfer clutch piston assembly.
- 3) Insert the transfer clutch piston, spring retainer, return spring and clutch spring retainer.
- 4) Using the ST and a press, install the snap ring.

CAUTION:

If the operation is performed with the dust cover installed, place a table between the extension case and the press table.

ST 18762AA001 COMPRESSOR SPECIAL TOOL

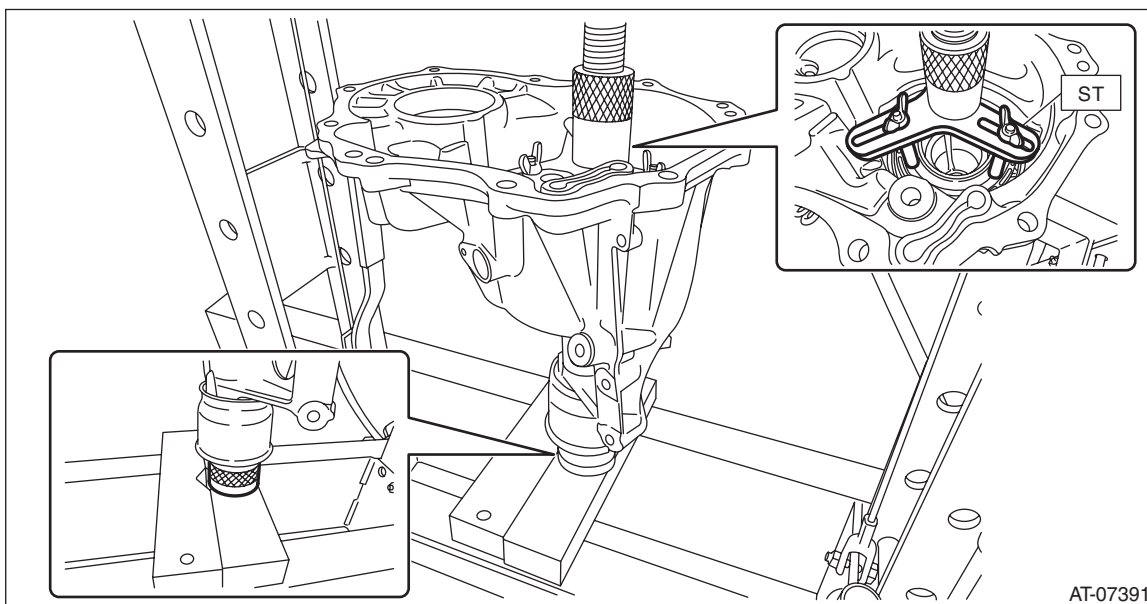

5) Press-fit the dust cover into extension case.

6) Install the extension case oil seal to extension case.

ST 498057300 INSTALLER

E: INSPECTION

- Use compressed air to make sure the extension case routes are not clogged or leaking.
- Check the D-rings and O-rings for damage.
- Make sure the snap ring is not worn and the return spring has no permanent distortion, damage, or deformation.
- Check the ball bearing for smooth rotation.
- Check the ball bearing for excessive looseness.
- Check there is no leak of CVTF from the joint between extension case and intermediate case.
- Check there is no damage or cracks on the extension case.

F: ADJUSTMENT

NOTE:

When replacing the extension case, select the rear drive shaft shim and transfer reduction driven gear shim.
<Ref. to CVT(TR690)-149, ADJUSTMENT, Rear Drive Shaft.> <Ref. to CVT(TR690)-161, ADJUSTMENT, Transfer Reduction Driven Gear.>